

M-8 / M-10 / M-14 / M-15

M-14 / M-15

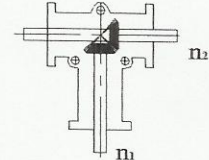
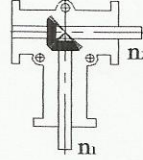
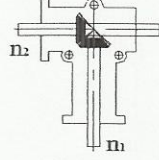
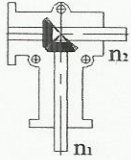

I

II

III

IV

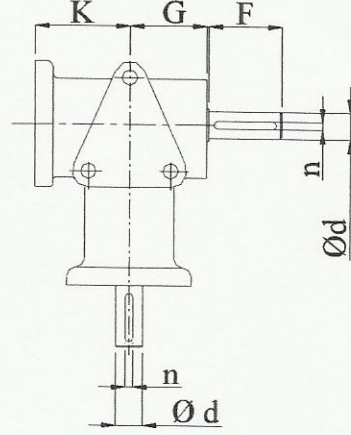
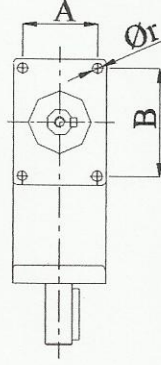
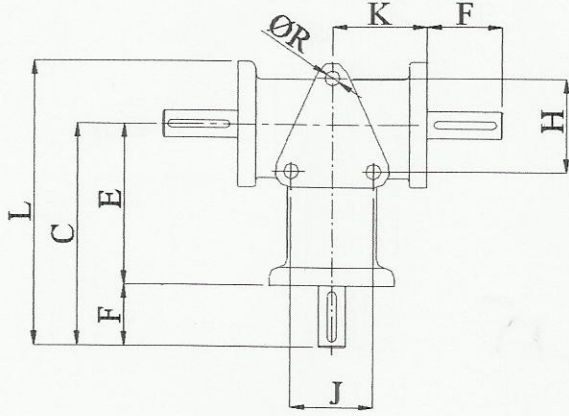

TİP / TYPE	A	B	C	Ød	E	F	G	H	J	K	L	n	Ør	ØR	Kg.
M-8	22	30	75	8	60	15	27	32	32	34	95	-	5.5	Ø5.5	0,5
M-10	24	34	80	10	60	20	30	38	38	40	102	-	5.5	Ø5.5	0,7
M-14	36	52	122	14	90	32	46	48	48	53	160	5	6.5	Ø8.5	1,1
M-15	36	52	122	15	90	32	46	48	48	53	160	5	6.5	Ø8.5	1,2

	i (n/n)	n ₁ (dv/dk)	n ₂ (dv/dk)	P (Kw/Hp)	M ₂ (Nm)		i (n/n)	n ₁ (dv/dk)	n ₂ (dv/dk)	P (Kw/Hp)	M ₂ (Nm)
M-8 M-10	1	1400	1400	0,37/0,5	2,5	M-14 M-15	1	1400	1400	1,1/1,5	7,4
		900	900	0,25/0,34	2,6		2	900	700	0,45/0,6	6
		500	500	0,15/0,2	2,8		1	900	900	1/1,3	1
							2	450	0,37/0,5	0,78	
							1	500	0,69/0,94	1,3	
							2	250	0,27/0,36	1	

Yağ Cinsi Oil Type	Kullanım Sıcaklığı Usage Temperature (°C)	ISO Viskozite Sınıfı ISO Viscosity Class	Kullanılan Yağlar / Oils used						
			ARAL	BP	ESSO	KLUBER	MOBIL	SHELL	TEXAGO
Mineral Gres Mineral Grease	-20.....+120		Aralup HL 2	Energrease LS 3	Beacon 3	Centoplex 2	Mobilux 2	Alvania R3	Multifak Premium 3
Sentetik Gres Synthetic Grease	-30.....+100					ISOFLEX Topas L152	Mobiltemp SHC 100	Cassida RLS 00	Synthetic 4602